

Diffuse reflection

PD-F41UA

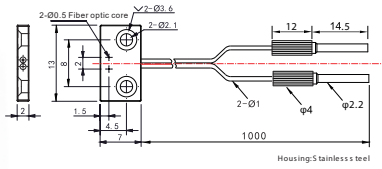
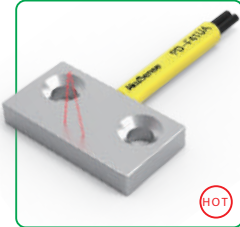

Sensing distance:
 Minimum bending radius: R 2 PC1:80mm
 Min- size D detected object:φ0 .05mm PG1:30mm

HOT

PD-F42UA

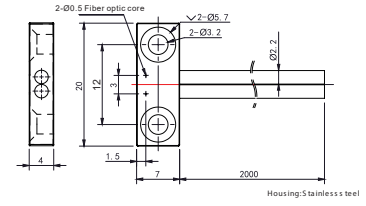

Sensing distance:
 Minimum bending radius: R 2 PC1:160mm
 Min- size D detected object:φ0 .05mm PG1:120mm

PD-F44UA

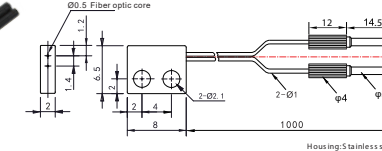
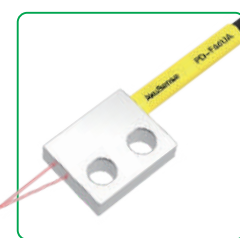

Sensing distance:
 Minimum bending radius: R 2 PC1:120mm
 Min- size D detected object:φ0 .05mm PG1:55mm

PD-F47UA

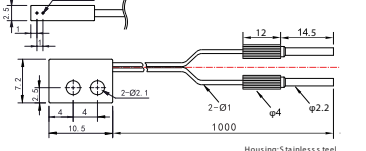

Sensing distance:
 Minimum bending radius: R 2 PC1:80mm
 Min- size D detected object:φ0 .05mm PG1:25mm

Thru-beam

PT-F51UA

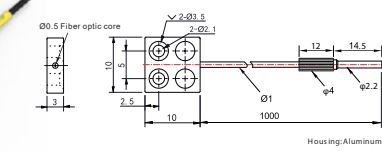
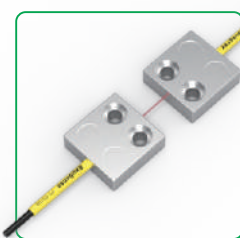

Sensing distance:
 Minimum bending radius: R 2 PC1:400mm
 Min- size D detected object:φ0 .05mm PG1:130mm

PT-F52UA

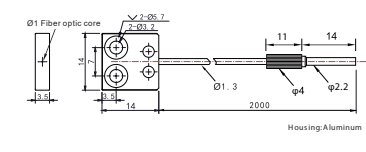
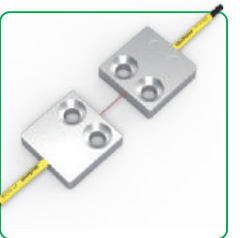

Sensing distance:
 Minimum bending radius: R 2 PC1:1900mm
 Min- size D detected object:φ0 .05mm
 (Sensing distance varies with different amplifiers)

PT-F53UA

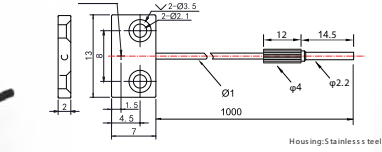

Sensing distance:
 Minimum bending radius: R 2 PC1:210mm
 Sensing distance:340mm
 Min- size D detected object:φ0 .05mm
 (Sensing distance varies with different amplifiers)

PT-F54UA

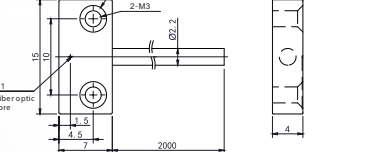
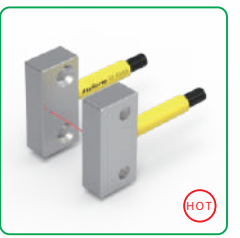

Sensing distance:
 Minimum bending radius: R 2 PC1:1300mm
 Min- size D detected object:φ0 .05mm PG1:450mm

PT-F57UA

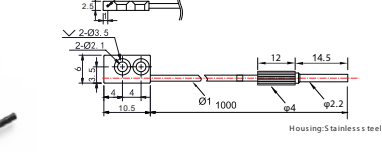
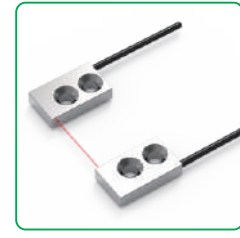

Sensing distance:
 Minimum bending radius: R 2 PC1:210mm
 Sensing distance:480mm
 Min- size D detected object:φ0 .05mm
 (Sensing distance varies with different amplifiers)

PT-FZ8

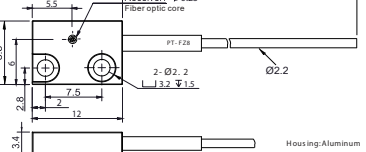
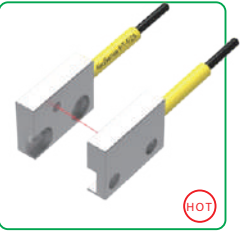

Sensing distance:
 Minimum bending radius: R 15 PC1:120mm
 Min- size D detected object:φ0 .1mm
 (Sensing distance varies with different amplifiers)

Fiber Optic

Slot Sensors

Photoelectric

Laser

Proximity

Displacement

Magnetic

Contact

Area

Ultrasonic

Vision

Vibration

Temperature

Annexes

Guidance

Fiber amplifiers

Standard economic

High stability type

High performance

High speed respon

Fiber components

Popular type

Array-type

Flat bracket type

Side-view type

High elastic type

High temperature resistant

Small spot type

Combination type

High end type

Fiber lens

Fiber lens