

Diffuse reflection

PD-F41UA

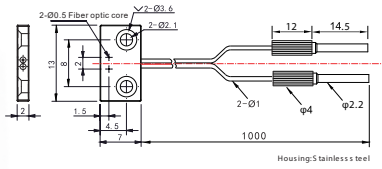
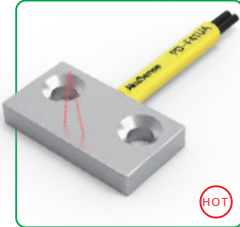

Sensing distance: PC1:80mm PG1:30mm
 Minimum bending radius: R 2
 Min- size D detected object:φ0 .05mm

HOT

PD-F42UA

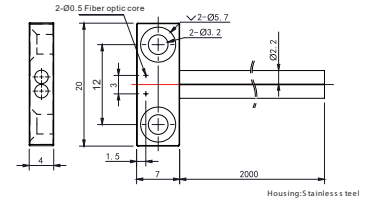

Sensing distance: PC1:160mm PG1:120mm
 Minimum bending radius: R 2
 Min- size D detected object:φ0 .05mm

PD-F44UA

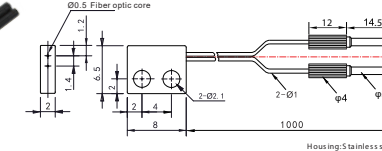
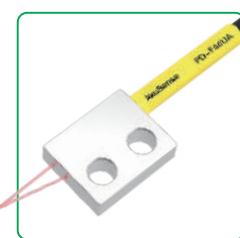

Sensing distance: PC1:120mm PG1:55mm
 Minimum bending radius: R 2
 Min- size D detected object:φ0 .05mm

PD-F47UA

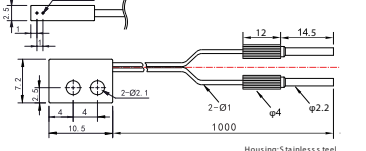

Sensing distance: PC1:80mm PG1:25mm
 Minimum bending radius: R 2
 Min- size D detected object:φ0 .05mm

Thru-beam

PT-F51UA

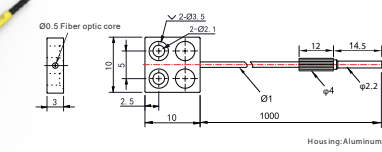
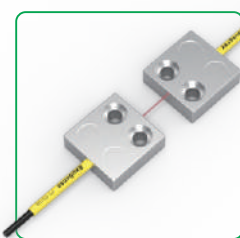

Sensing distance: PC1:400mm PG1:130mm
 Minimum bending radius: R 2
 Min- size D detected object:φ0 .05mm

PT-F52UA

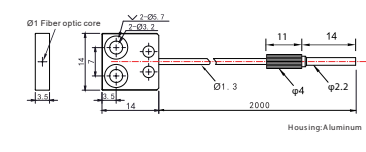
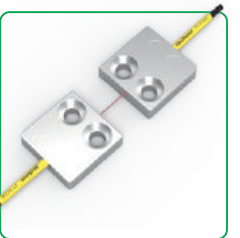

Sensing distance: 1900mm
 Minimum bending radius: R 2
 Min- size D detected object:φ0 .05mm
 (Sensing distance varies with different amplifiers)

PT-F53UA

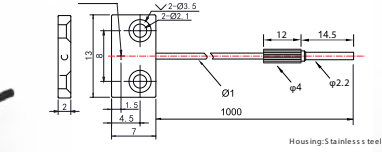

Sensing distance: PC1:210mm PG1:80mm
 Minimum bending radius: R 2
 Sensing distance:340mm
 Min- size D detected object:φ0 .05mm
 (Sensing distance varies with different amplifiers)

PT-F54UA

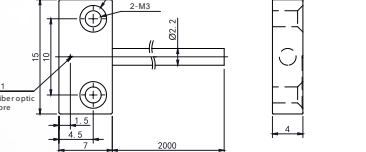
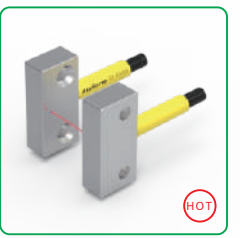

Sensing distance: PC1:1300mm PG1:450mm
 Minimum bending radius: R 2
 Min- size D detected object:φ0 .05mm

HOT

PT-F57UA

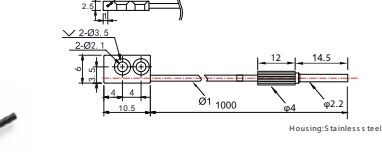
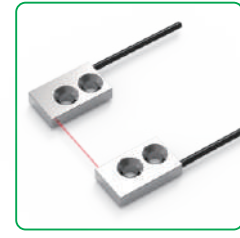

Sensing distance: PC1:100mm PG1:400mm
 Minimum bending radius: R 2
 Sensing distance:480mm
 Min- size D detected object:φ0 .05mm
 (Sensing distance varies with different amplifiers)

PT-FZ8

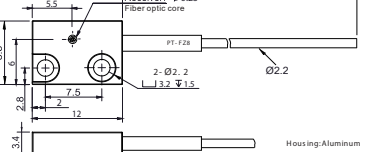
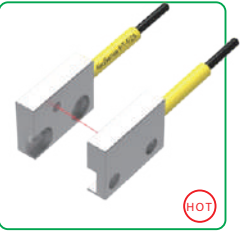

Sensing distance: 1200mm
 Minimum bending radius: R 15
 Min- size D detected object:φ0 .1mm
 (Sensing distance varies with different amplifiers)

HOT

Fiber Optic

Slot Sensors

Photoelectric

Laser

Proximity

Displacement

Magnetic

Contact

Area

Ultrasonic

Vision

Vibration

Temperature

Annexes

Guidance

Fiber amplifiers

Standard economic

High stability type

High performance

High speed respon

Fiber components

Popular type

Array-type

Flat bracket type

Side-view type

High elastic type

High temperature resistant

Small spot type

Combination type

High end type

Fiber lens

Fiber lens